



Sinclair  Hammelton

ASKING PRICE

£1,500,000

Baston Road

Hayes, BR2 7BS

EPC RATING: COUNCIL TAX BAND: NEW BUILD

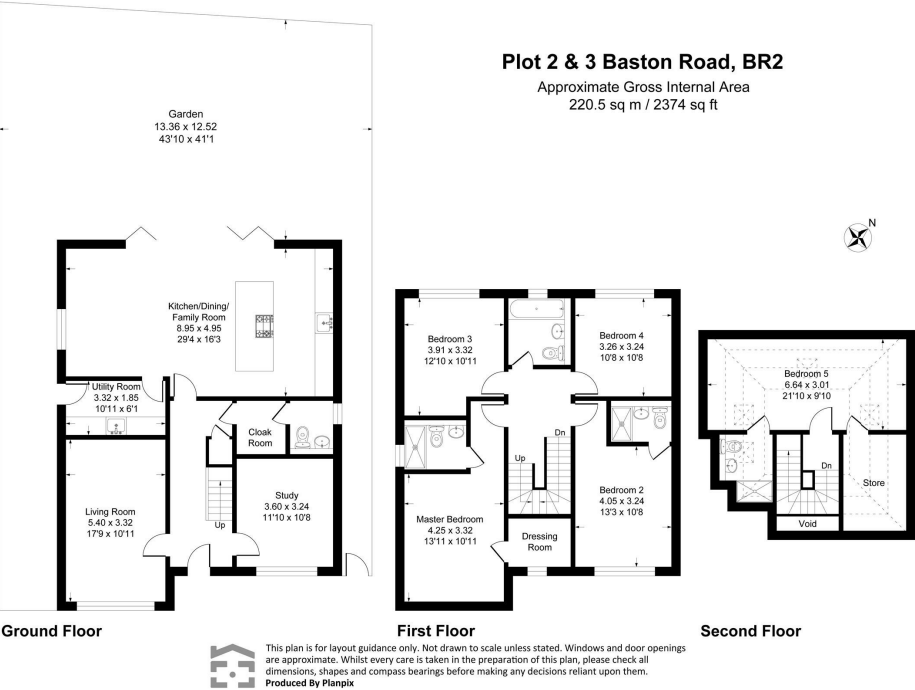

Energy Efficiency Rating		
	Current	Potential
Very energy efficient - lower running costs		
(92 plus) A		
(81-91) B		
(69-80) C		
(55-68) D		
(39-54) E		
(21-38) F		
(1-20) G		
Not energy efficient - higher running costs		
England & Wales	EU Directive 2002/91/EC	



Agents Note: Whilst every care has been taken to prepare these particulars, they are for guidance purposes only. All measurements are approximate and are for general guidance purposes only and whilst every care has been taken to ensure their accuracy, they should not be relied upon and potential buyers/tenants are advised to recheck the measurements

Sinclair Hammelton

OFFICE ADDRESS
3a Station Approach
Hayes
Kent
BR2 7EQ

OFFICE DETAILS
020 8462 0360
infohy@sinclairhammelton.co.uk